



**Profilex s.a.**

6b, Z.I. In den Allern  
L-9911 Troisvierges  
Phone LU : +352 99 89 06  
Phone BE : +32 28 88 16 29  
Fax : +352 26 95 73 73

[info@profilex-systems.com](mailto:info@profilex-systems.com)  
[www.profilex-systems.com](http://www.profilex-systems.com)

PREASSEMBLED ELEMENTS FOR LIFTING AND SLIDING DOORS

All elements are preassembled from our standard products ready for use. They are easily fixed to our profiles by using our fastening elements. Stock of parts is not necessary and planning and assembly time can be reduced significantly.

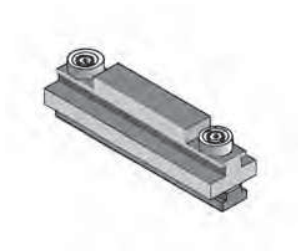

**Slide-roll element**

For one door four elements are necessary:

- One each to be fixed at end positions of pillar.
- One each to be fixed at door element.

**Length of sliding profile:**

desired stroke + 180 mm min.

1. Disassemble slide-roll element.
2. Insert T-slot bar into profile groove and fix at desired position.
3. Reassemble the slide-roll element and lock with glue.

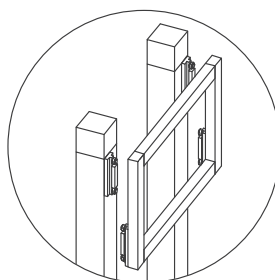

Assembly in front of pillars.  
Gap = 8 mm

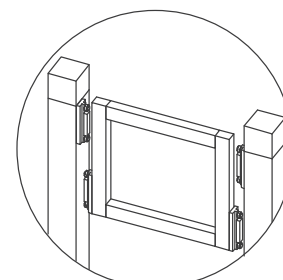

Assembly between pillars.  
Gap = 8 mm

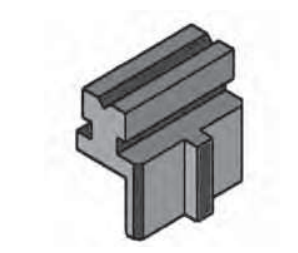

**Guide for sliding-door**

For a simultaneous guidance of two elements in one profile groove. Subsequent mounting of sliding-doors into existing constructions possible. For one door element 4 guides are necessary.

**Allow for door elements:**

Height: clearance of the opening minus 11 mm  
Width for 2 elements:  $\frac{\text{clear width} + 55}{2}$

## CABLE PULLEY 45

part no. 21.1775/0

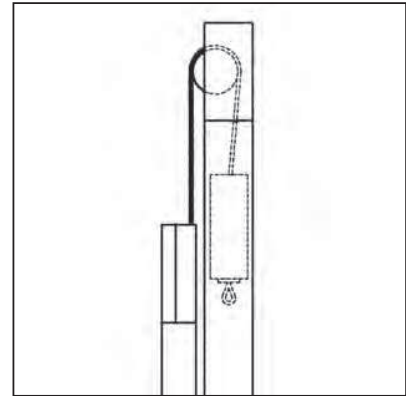
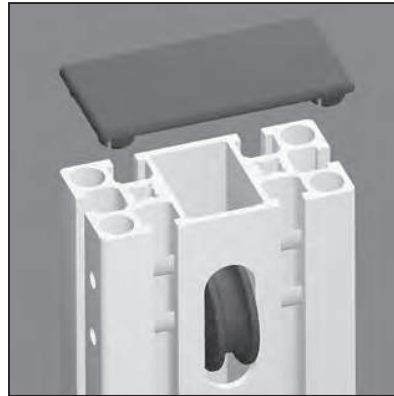
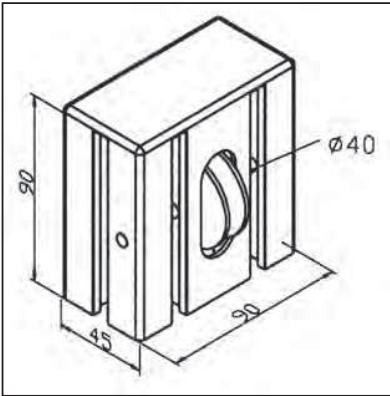

### TECHN. DATA / ITEMS SUPPLIED

- Housing made of profile 45 x 90
- Cable roller preassembled; built-in on broad side of the profile
- End cap
- Weight 0,350 kg
- Load max. 12 kg

### APPLICATIONS

- Cable reverse for counterweights in lifting doors made of profiles 45 x 90 L or 45 x 90 G
- For continuous operation and heavy loads use chain pulley 45

### ASSEMBLY

- Attachment on vertical profile with 2 T-slot bars 90 **part no. 21.1029/0**
- Corresponding cable **part no. 21.1777/0** is a wear part and must be regularly checked and lubricated if required

## CABLE PULLEY 90

part no. 21.1776/0

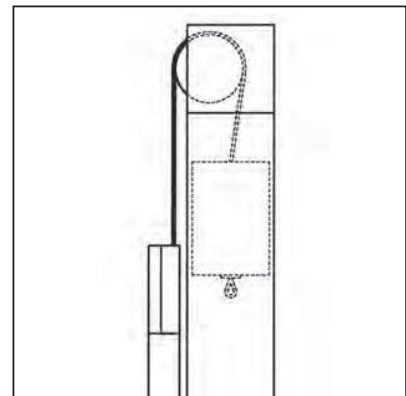
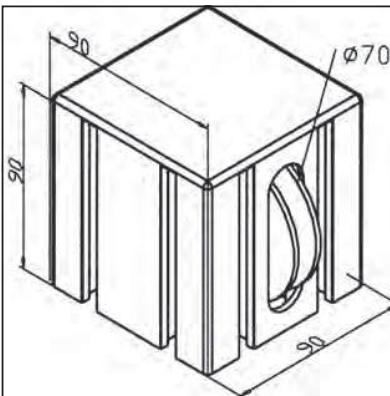

### TECHN. DATA / ITEMS SUPPLIED

- Housing made of profile 90 x 90 L
- Built-in cable roller St, zinc plated
- End cap
- Weight 0,680 kg
- Load max. 30 kg

### APPLICATIONS

- Cable reverse for counterweights in lifting doors made of profiles 90 x 90 L
- For continuous operation and heavy loads use chain pulley 90

### ASSEMBLY

- Attachment on vertical profile with 4 T-slot bars 90 **part no. 21.1029/0**
- Corresponding cable **part no. 21.1777/0** is a wear part and must be regularly checked and lubricated if required

## END BLOCK

part no. 21.1780/0

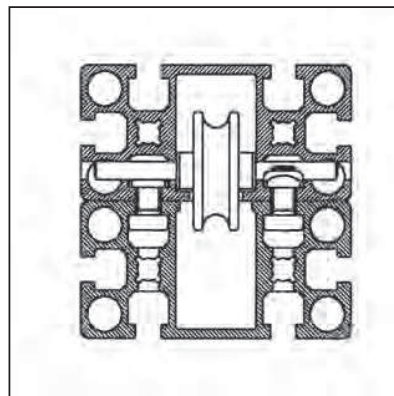
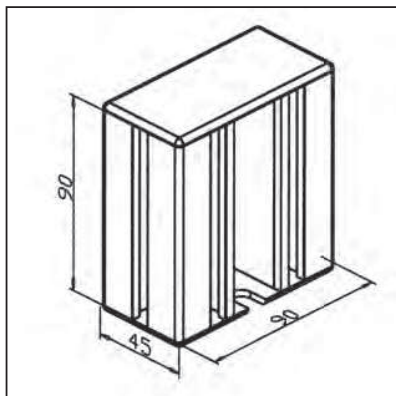

### TECHN. DATA / ITEMS SUPPLIED

- Profile 45 x 90
- End caps 45 x 90, one with slot for cable passage
- Fastening kit
- Weight 0,290 kg
- Length 90 mm

### APPLICATIONS

- Safety device for cable pulleys

### ASSEMBLY

- Use fastening kit

## CABLE

part no. 21.1777/0

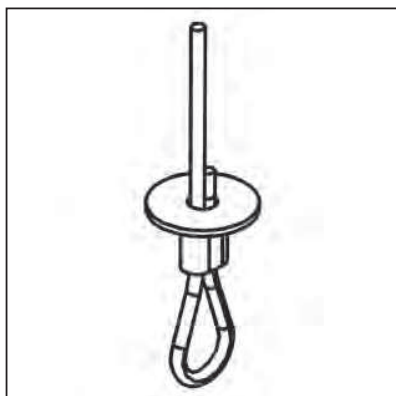

### TECHN. DATA / ITEMS SUPPLIED

- Steel cable VA, 2,5 mm
- With clamping eye hook on one side, pressed
- Weight 0,072 kg/m
- Length 2,5 m
- On request also deliverable in other lengths

### APPLICATIONS

- Use in connection with counterweight 45 or 90 and cable pulleys

### ASSEMBLY

- Lead the cable through the center bore and into the counterweight
- Fasten the cable with the cable clamping device **part no. 21.1797/0** on the lifting door
- Cable is a wear part and must be regularly checked and lubricated if required

## ROPE CLAMP

part no. 21.1797/0

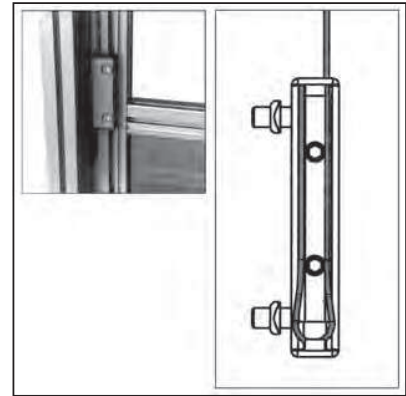
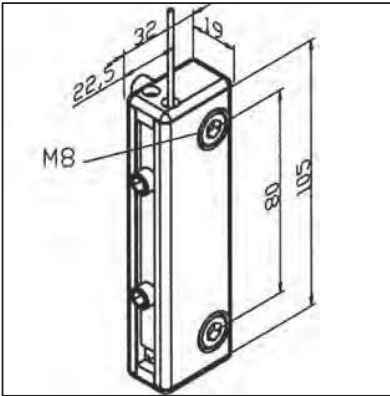

### TECHN. DATA / ITEMS SUPPLIED

- Profile 19 x 32
- 1 Clamping plate
- 2 hex socket cap screws with square nuts
- 2 End caps, one with throughbore
- Weight 0,149 kg

### APPLICATIONS

- Connection of counterweight and door element in lifting doors

### ASSEMBLY

- Remove lower end cap and unscrew set screw
- Attach rope clamp with fastening kit at the top of the door element
- Pull the rope through the bore of the upper end cap
- Put the counterweight in desired position (test in upper and lower end position of the door element)
- Lay rope end in loop around clamping plate, slide into the slot and fix the two set screws
- If necessary cut cable end and fix lower end cap

## SYNCHRONOUS PULLEY 45

part no. 21.1792/0

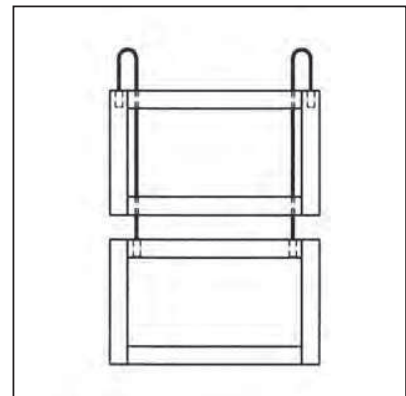
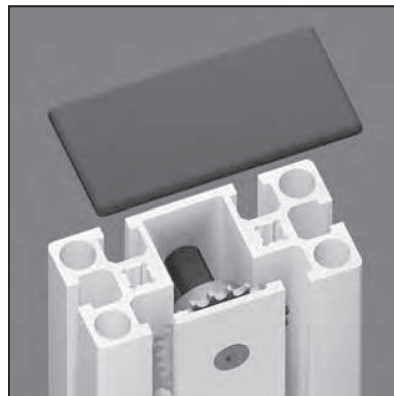
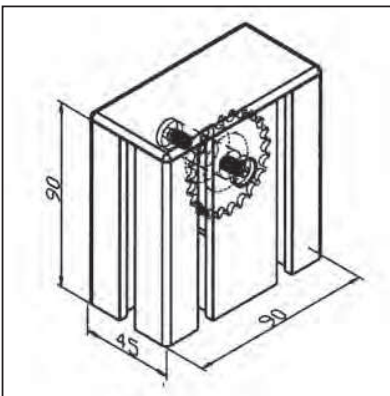

### TECHN. DATA / ITEMS SUPPLIED

- Housing made of profile 45 x 90
- Chain wheel, steel, preassembled for installation on broad side of the profile
- Weight 0,343 kg
- Load max. 34 kg

### APPLICATIONS

- Simultaneous opening and closing of two lifting doors running in the operate direction; doors are of similar weight
- The chain is guided in the profile groove, thus no hand-protection is required

### ASSEMBLY

- Attachment on vertical profile with 2 T-slot bars 90 **part no. 21.1029/0**
- Insert chain **part no. 21.1713/0** in pulley; fasten it with the door chain clamping device **part no. 21.1712/0** on both doors and insert it in the vertical profiles

## CHAIN PULLEY 32

part no. 21.1774/0

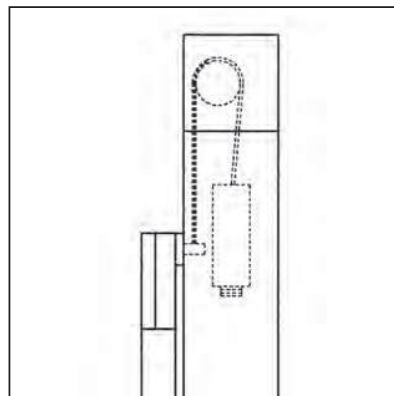
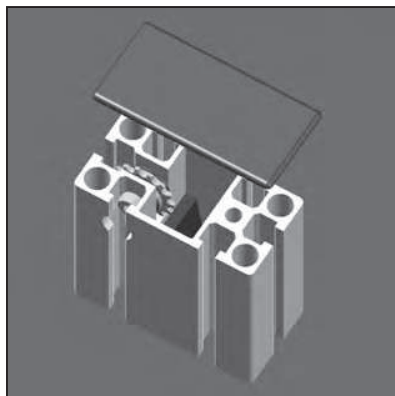
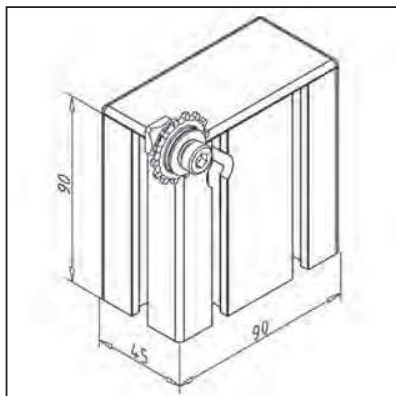

### TECHN. DATA / ITEMS SUPPLIED

- Housing made of profile 45 x 90
- Chain wheel, steel, zinc plated, preassembled, for small profile side
- End cap
- Weight 0,388 kg
- Load max. 50 kg

### APPLICATIONS

- Chain reverse for counterweights in lifting doors; for inner balancing weight in profiles 45 x 90 F or 45 x 90 G
- The cable is guided in the profile groove, thus no hand-protection is required

### ASSEMBLY

- Attachment on vertical profiles with 2 slot-bars 90 **part no. 21.1029/0**
- Applications of chain **part no.. 21.1713/0** with door chain clamping device **part no. 21.1712/0** and weight chain clamping device **part no. 21.1711/0**

## CHAIN PULLEY 45 A

part no. 21.1838/0

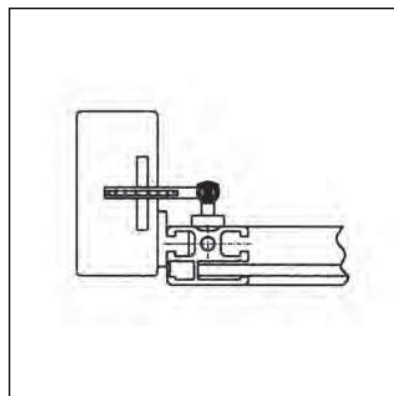
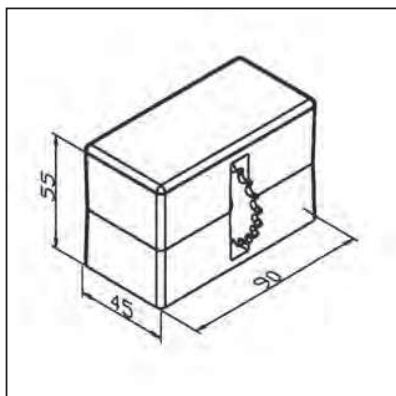

### TECHN. DATA / ITEMS SUPPLIED

- Housing aluminium GD, powder coated, grey
- Chain wheel, steel, zinc plated, preassembled
- End cap
- Fastening kit
- Weight 0,347 kg
- Load max. 50 kg

### APPLICATIONS

- Chain reverse of counterweights for lifting doors for inner counterweight in profile 45 x 90 L or 45 X 90 G
- Chain runs on the outer profile side and in the middle of te broad side; if required covered with hand-protection **part no. 21.1780/0**

### ASSEMBLY

- Attachment with fastening kit from supply schedule; thread M8 in vertical profile required
- Use of chain **part no.. 21.1713/0** with door chain clamping device **part no. 21.1712/0** and weight chain clamping device **part no. 21.1711/0**

## CHAIN PULLEY 45 I

part no. 21.1840/0

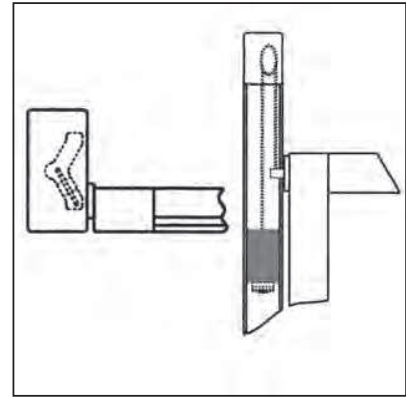
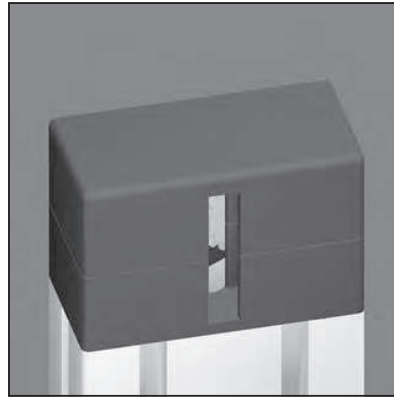
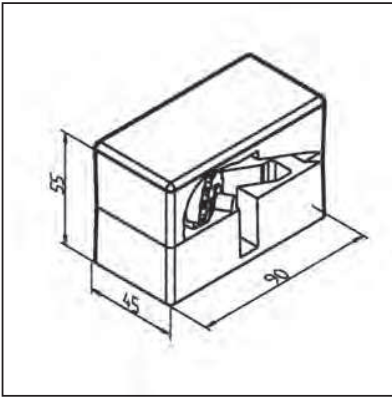

### TECHN. DATA / ITEMS SUPPLIED

- Housing aluminium GD, powder coated, grey
- Chain wheel, steel, zinc plated, preassembled
- End cap
- Fastening kit
- Weight 0,347 kg
- Load max. 50 kg

### APPLICATIONS

- Chain reverse of counterweights for lifting doors for inner counterweight in profile 45 x 90 L or 45 X 90 G
- Chain runs on the broad side of the profile in the right or left profile groove (adjustable chain wheel), no hand-protection required

### ASSEMBLY

- Attachment with fastening kit; thread M8 in vertical profile required
- Use of chain **part no.. 21.1713/0** with door chain clamping device **part no. 21.1712/0** and weight chain clamping device **part no. 21.1711/0**

## CHAIN PULLEY 90

part no. 21.1839/0

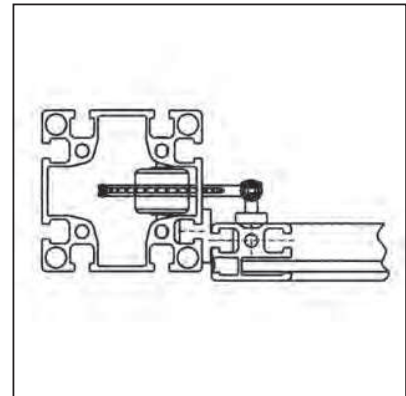
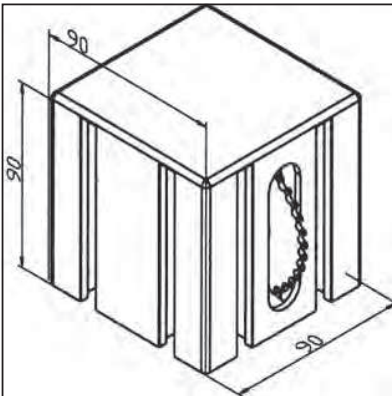

### TECHN. DATA / ITEMS SUPPLIED

- Housing aluminium GD, powder coated, grey
- Chain wheel, steel, zinc plated, preassembled
- End cap
- Weight 0,681 kg
- Load max. 70 kg

### APPLICATIONS

- Chain reverse for counterweights for lifting doors, for inner balancing weight in profile 90 x 90 L
- The chain is guided on the outside and in the middle of the profile surface; cover with hand-protection **part no. 21.1780/0**

### ASSEMBLY

- Attachment on vertical profiles with 4 slot-bars **part no. 21.1029/0**
- Use of chain **part no.. 21.1713/0** with door chain clamping device **part no. 21.1712/0** and weight chain clamping device **part no. 21.1711/0**



## CHAIN 04

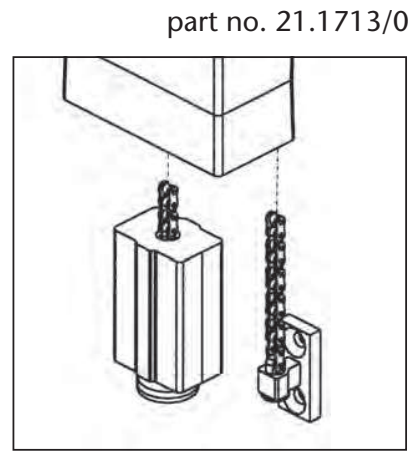
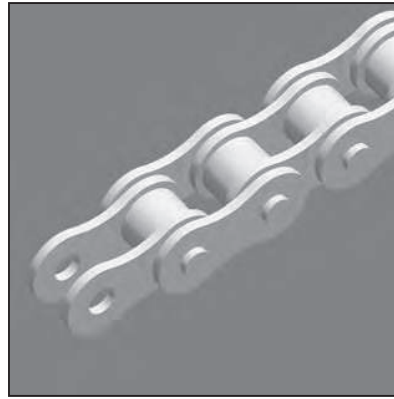
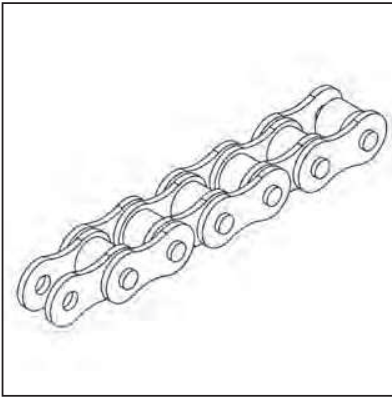

part no. 21.1713/0

### TECHN. DATA / ITEMS SUPPLIED

- Roller chain, steel
- Size 4
- Weight 0,120 kg/m
- Breaking load min. 3000 N
- **Please indicate desired length**

### APPLICATIONS

- Use in connection with counterweight 45 or 90 and chain pulleys
- Use in connection with door chain clamping device **part no. 21.1712/0** for fastening the chain on the door
- Use in connection with weight chain clamping device **part no. 21.1711/0** for fastening the chain on the side of the counterweight

### ASSEMBLY

- Lead the chain through the counterweight and through the fastening kit for chain (counterweight side) **part no. 21.1711/0** mount chain lock
- For mounting on door lead chain through fastening kit for chain (door side) **part no. 21.1712/0**

## DOOR CHAIN CLAMPING DEVICE

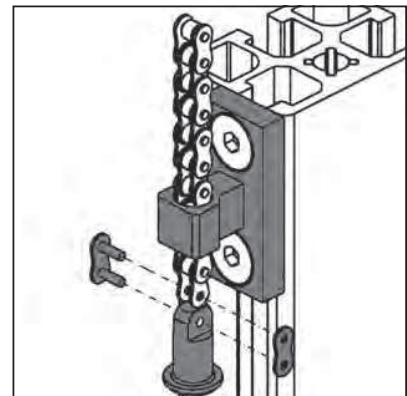
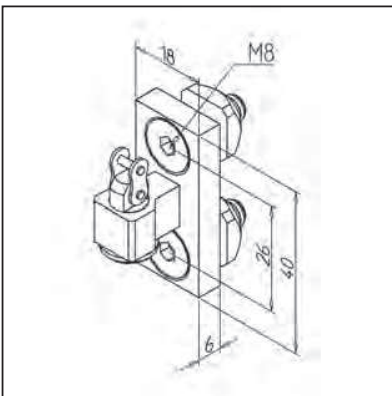

part no. 21.1712/0

### TECHN. DATA / ITEMS SUPPLIED

- Steel zinc plated
- Fastening kit
- Weight 0,060 kg

### APPLICATIONS

- Use in connection with counterweight 45 or 90 and pulleys
- Use in connection with chain clamping device **part no. 21.1713/0** for fastening on door side

### ASSEMBLY

- Lead the chain through the counterweight and through the fastening kit for chain (counterweight side) **part no. 21.1711/0** mount chain lock
- For mounting on door lead chain through fastening kit for chain (door side) **part no. 21.1712/0** and mount bolt with link for chain

## DOOR CHAIN CLAMPING DEVICE KV-32

part no. 21.1980/0

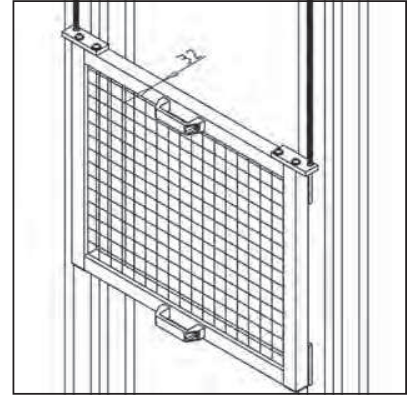
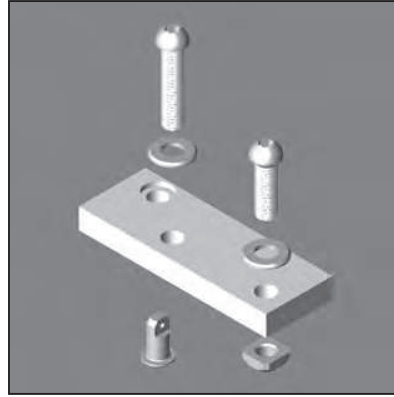
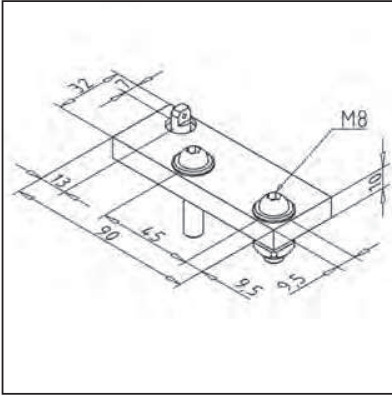

### TECHN. DATA / ITEMS SUPPLIED

- Steel zinc plated
- Fastening kit and link for chain
- Weight 0,247 kg

### APPLICATIONS

- Use in connection with chain pulley 90 and chain 04
- Mount lifting doors from profile 45 x 32 with Slide-roll element in front of pillars

### ASSEMBLY

- Mount plate to lifting doors with the supplied lock chain roller 04
- Use 2 door chain clamping every lifting doors

## DOOR CHAIN CLAMPING DEVICE KV-45

part no. 21.1981/0

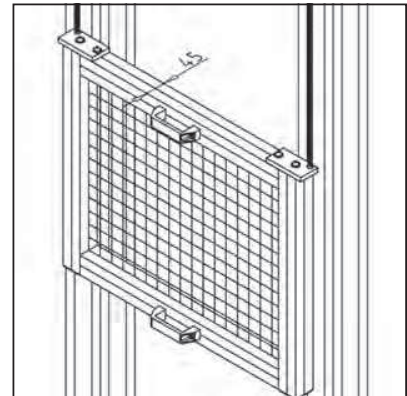
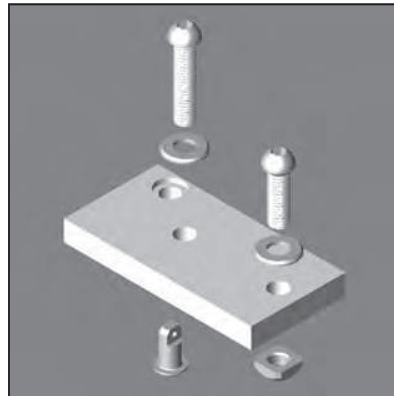
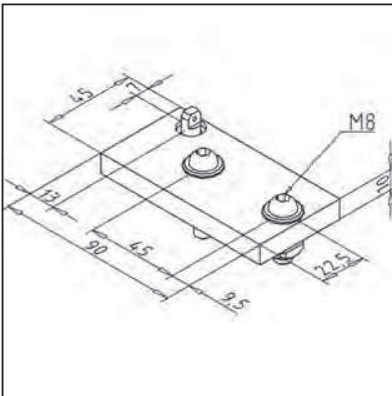

### TECHN. DATA / ITEMS SUPPLIED

- Steel zinc plated
- Fastening kit and chain lock
- Weight 0,345 kg

### APPLICATIONS

- Use in connection with chain pulley 90 and chain 04
- Mount lifting doors from profile 45 x 45 with Slide-roll element in front of pillars

### ASSEMBLY

- Mount plate to lifting doors with the supplied lock chain roller 04
- Use 2 door chain clamping every lifting doors



## DOOR CHAIN CLAMPING DEVICE KI-32

part no. 21.1982/0

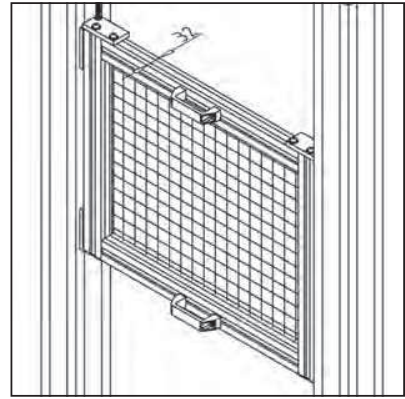
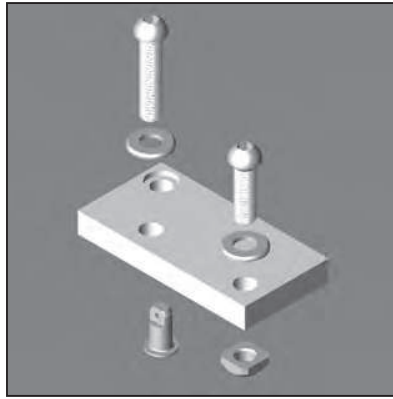
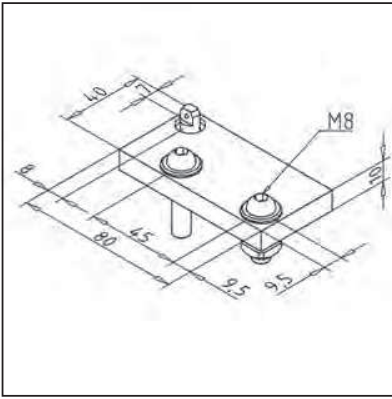

### TECHN. DATA / ITEMS SUPPLIED

- Steel zinc plated
- Fastening kit and link for chain
- Weight 0,278 kg

### APPLICATIONS

- Use in connection with chain pulley 90 and chain 04
- Mount lifting doors from profile 45 x 32 with Slide-roll element in front of pillars

### ASSEMBLY

- Mount plate to lifting doors with the supplied lock chain roller 04
- Use 2 door chain clamping every lifting doors

## DOOR CHAIN CLAMPING DEVICE KI-45

part no. 21.1983/0

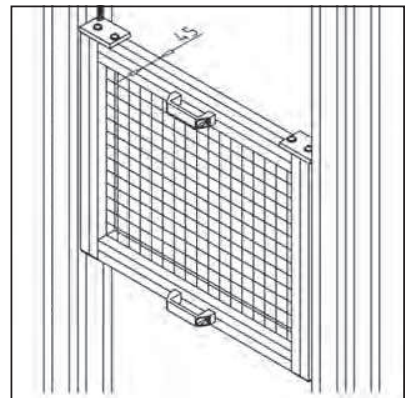
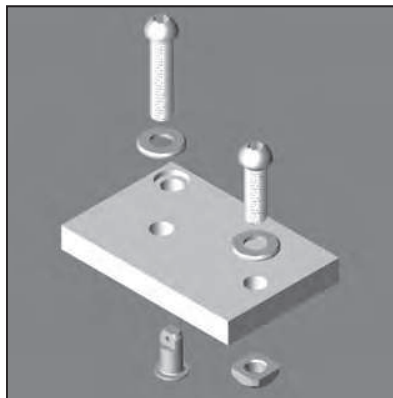
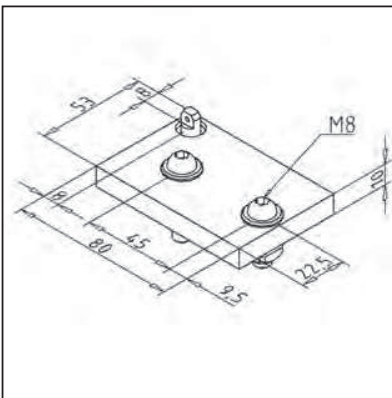

### TECHN. DATA / ITEMS SUPPLIED

- Steel zinc plated
- Fastening kit and link for chain
- Weight 0,360 kg

### APPLICATIONS

- Use in connection with chain pulley 90 and chain 04
- Mount lifting doors from profile 45 x 32 with Slide-roll element in front of pillars

### ASSEMBLY

- Mount plate to lifting doors with the supplied lock chain roller 04
- Use 2 door chain clamping every lifting doors

## FASTENING KIT FOR CHAIN (COUNTERWEIGHT)

part no. 21.1711/0

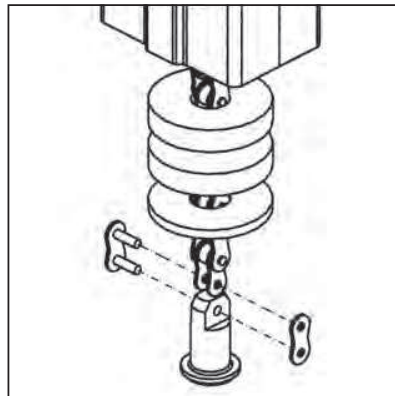
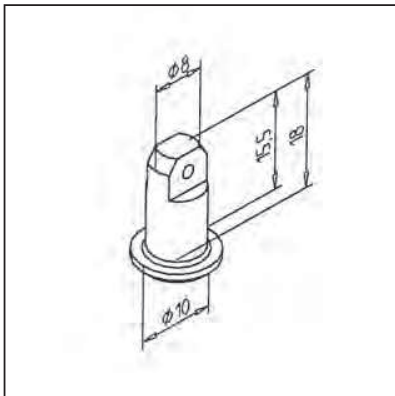

### TECHN. DATA / ITEMS SUPPLIED

- Steel, zinc plated
- Rubber-ring
- Link for chain
- Weight 0,015 kg

### APPLICATIONS

- Use in connection with counterweight 45 or 90 and pulleys
- Use in connection with chain 04 **part no. 21.1713/0** to fasten chain to counterweight

### ASSEMBLY

- Lead the chain through the counterweight and through the fastening kit for chain (counterweight side) **part no. 21.1711/0** mount chain lock
- For mounting on door lead chain through fastening kit for chain (door side) **part no. 21.1712/0**

## CHAIN REVERSE 90 S

part no. 21.0920/0

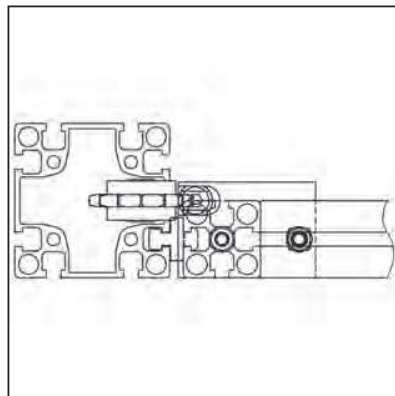
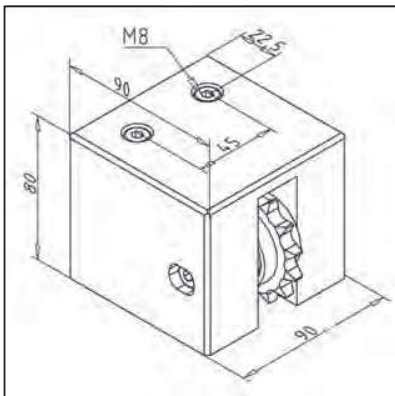

### TECHN. DATA / ITEMS SUPPLIED

- Aluminium anodized
- Fastening kit
- Weight 1,748 kg
- Load max. 150 kg

### APPLICATIONS

- Chain reverse for counterweights for lifting doors, for inner balancing weight in profile 90 x 90 L

### ASSEMBLY

- Use fastening kit
- Use of chain 08 **part no. 29-0307/0** with weight chain clamping device **part no. 21.0925/0**

## CHAIN 08

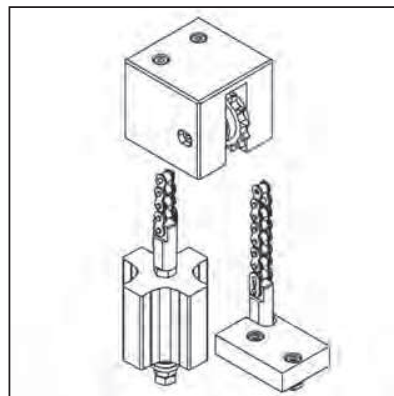
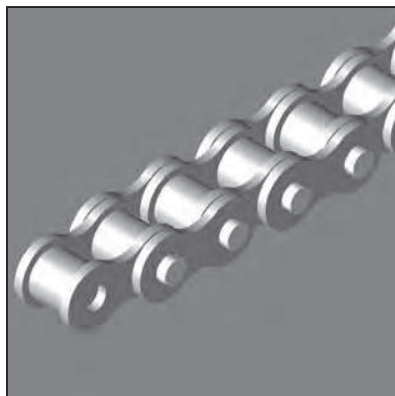
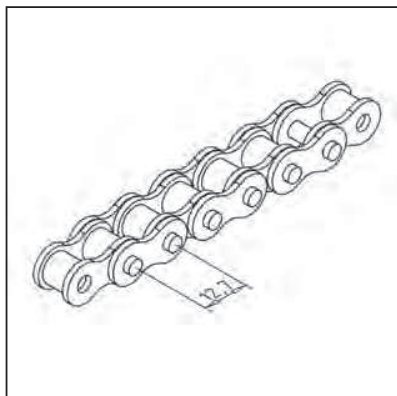

part no. 29.0307/0

### TECHN. DATA / ITEMS SUPPLIED

- Chain, steel
- Size 8
- Weight 0,700 kg/m
- Breaking load min. 18.000 N
- **Please indicate desired length**

### APPLICATIONS

- Use in connection with counterweight 45 or 90 and chain reverse 90 S
- Fastening kit for chain (counterweight) S **part no. 21.0925/0**

### ASSEMBLY

- Mounting by Fastening kit for chain (counterweight) S **part no. 21.0925/0** of M10 threaded rod **part no. 21.1667/0** for receiving the counterweight

## DOOR CHAIN CLAMPING DEVICE 90 S FRONT

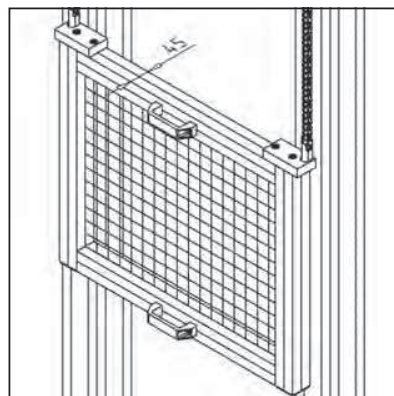
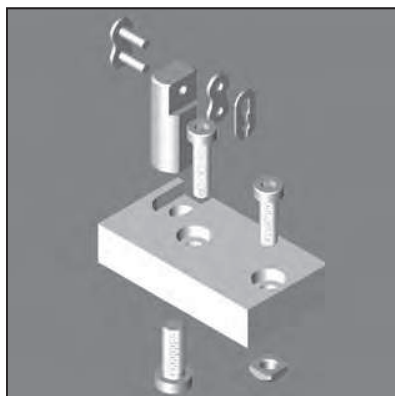
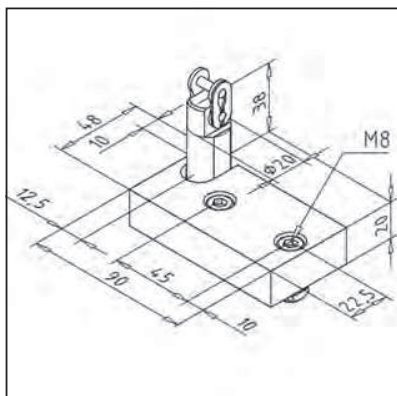

part no. 21.0927/0

### TECHN. DATA / ITEMS SUPPLIED

- Aluminium anodized
- Fastening kit and link for chain
- Weight 0,381 kg

### APPLICATIONS

- Use in conjunction with chain reverse 90 S and chain 08
- Mount lifting doors from profile 45 x 45 with Slide-roll element in front of pillars

### ASSEMBLY

- Mount plate to lifting doors with the supplied lock chain roller 08
- Use 2 door chain clamping every lifting doors

## DOOR CHAIN CLAMPING DEVICE 90 S SIDWAY

part no. 21.0928/0

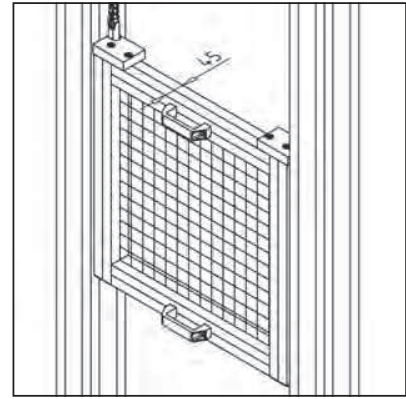
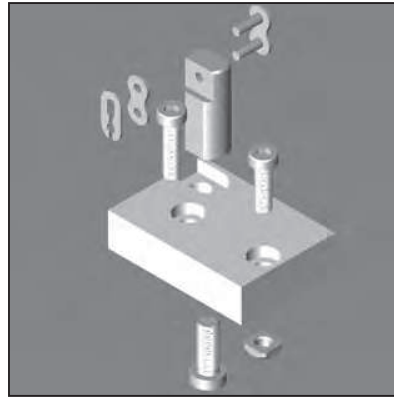
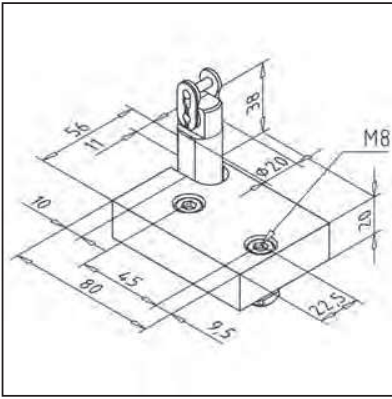

### TECHN. DATA / ITEMS SUPPLIED

- Aluminium anodized
- Fastening kit and link for chain
- Weight 0,368 kg

### APPLICATIONS

- Use in conjunction with chain reverse 90 S and chain 08
- Mount lifting doors from profile 45 x 45 with Slide-roll element in front of pillars

### ASSEMBLY

- Mount plate to lifting doors with the supplied lock chain roller 08
- Use 2 door chain clamping every lifting doors

## DOOR CHAIN CLAMPING DEVICE 90 S SLIDE

part no. 21.0929/0

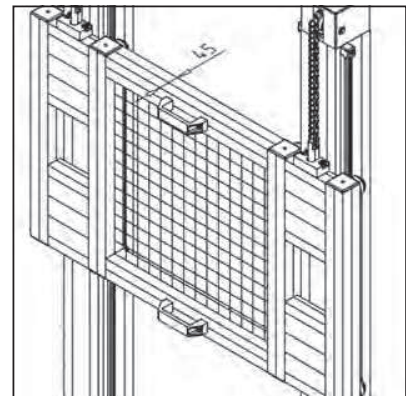
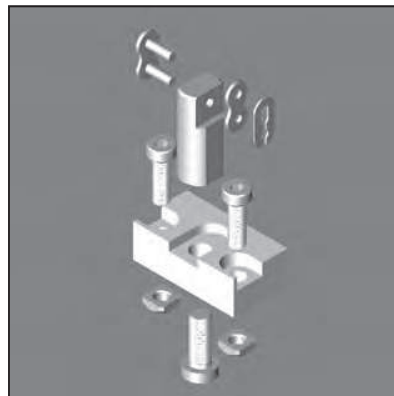
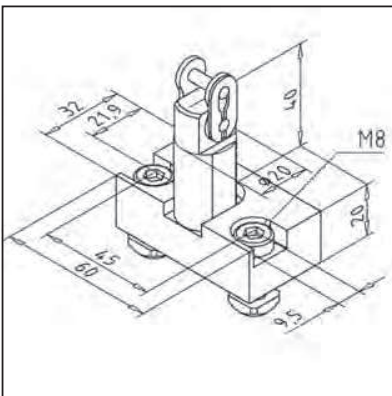

### TECHN. DATA / ITEMS SUPPLIED

- Aluminium anodized
- Fastening kit and link for chain
- Weight 0,375 kg

### APPLICATIONS

- Use in conjunction with chain reverse 90 S and chain 08
- For mounting on slide LW 45 or LW 90

### ASSEMBLY

- Mount plate to slide with the supplied lock chain roller 08

## DOOR CHAIN CLAMPING DEVICE (COUNTERWEIGHT) S

part no.  
21.0925/0

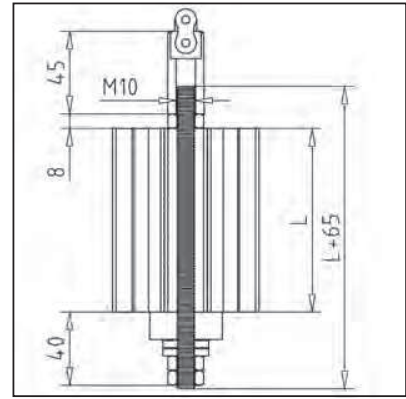
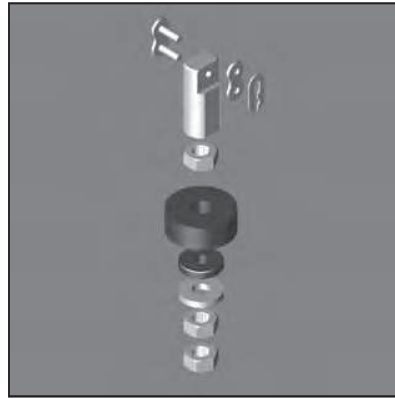
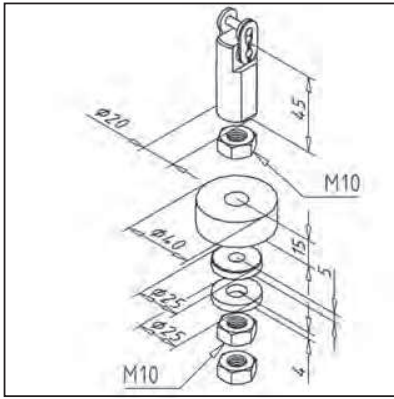

### TECHN. DATA / ITEMS SUPPLIED

- Steel, zinc plated
- Rubber-ring
- Link for chain
- Weight 0,145 kg (ohne Gewindestange)
- Please order threaded rod M 10 **part no. 21.1667/0** in addition to desired length

### APPLICATIONS

- Use in connection with counterweight 45 or 90 and pulleys
- Use in connection with chain **part no. 21.1713/0** to fasten chain to counterweight

### ASSEMBLY

- Lead the chain through the counterweight and through the fastening kit for chain (counterweight side) **part no. 21.1711/0** mount chain lock
- For mounting on door lead chain through fastening kit for chain (door side) **part no. 21.1712/0**
- Connect threaded rod with enclosed chain lock chain

## COUNTERWEIGHT 45

part no. 21.1772/0

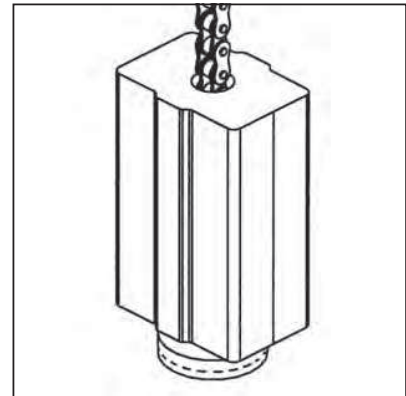
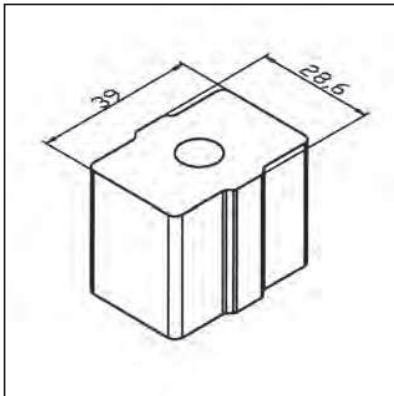

### TECHN. DATA / ITEMS SUPPLIED

- Pb cast, special hard
- For profiles 45 x 90 L or 45 x 90 G
- Weight 10 kg/m
- Length 0,330 m

### APPLICATIONS

- Counterweight for large lifting doors
- For cable and chain

### ASSEMBLY

- Insert the counterweight into the profile



## COUNTERWEIGHT 90

part no. 21.1778/0

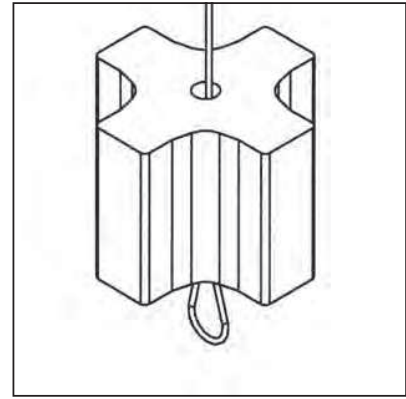
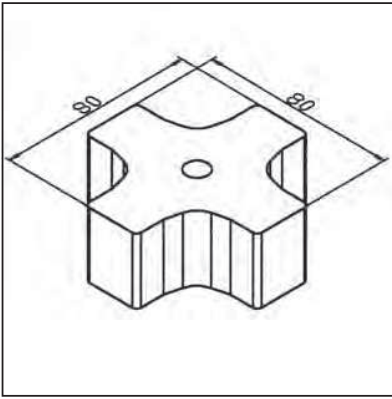

### TECHN. DATA / ITEMS SUPPLIED

- Pb cast, special hard
- For profiles 90 x 90
- Weight 38,5 kg/m
- Length 0,260 m

### APPLICATIONS

- Counterweight for large lifting doors
- For cable and chain

### ASSEMBLY

- Insert the counterweight into the profile

## SLIDE-ROLL ELEMENT

part no. 21.1796/0

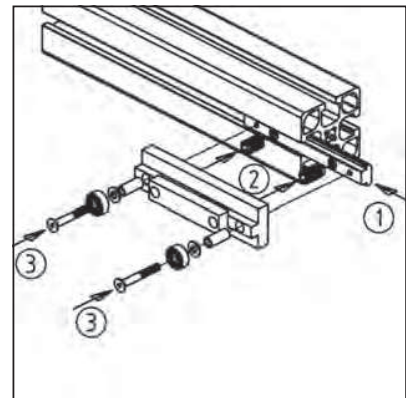
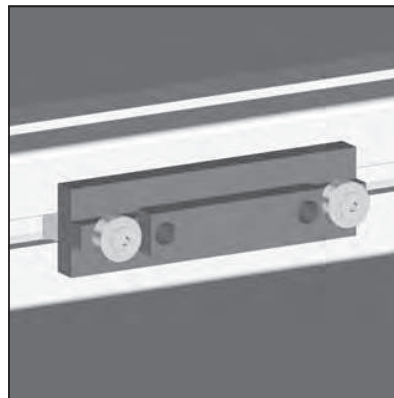
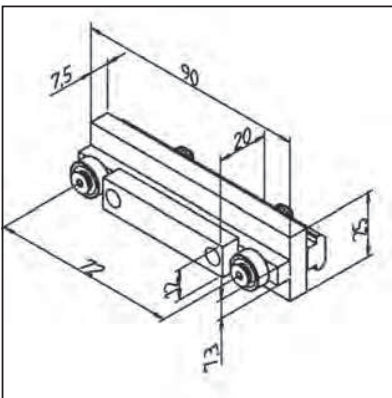

### TECHN. DATA / ITEMS SUPPLIED

- Hard plastic black, highly wear-resistant
- 1 T-slot bar, steel, zinc plated
- 2 ball-bearings, premounted
- Weight 0,093 kg
- Load max. 200 N

### APPLICATIONS

- Guide for lifting doors in the groove of the vertical profile
- Light linear slides
- Workpiece-slides, drawers

### ASSEMBLY

- 1: Disassemble the bearings from the element
- 2: Insert t-slot bar into profile groove and lock at desired position
- 3: Reassemble the slide and the bearings with t-slot bar, secure with suitable glue

## GLIDE-ROLL ELEMENT

part no. 21.1799/0

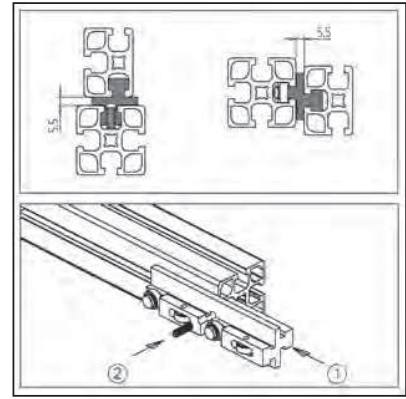
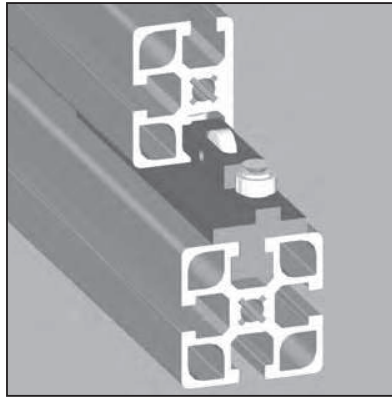
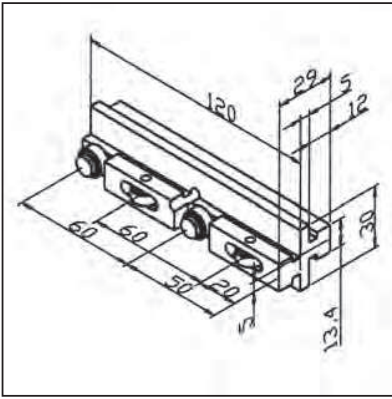

### TECHN. DATA / ITEMS SUPPLIED

- Hard plastic black, highly wear-resistant
- 1 clamping screw, steel, zinc plated
- 4 built-in ball-bearings
- Weight 0,060 kg
- F max 300 N

### APPLICATIONS

- Guide for sliding doors, lifting-doors, workpiece-slides, light linear guides
- The element provides 5 mm eccentricity for the construction of sliding doors with 2 casements or guides with 5 mm ground clearance

### ASSEMBLY

- 1: Insert the element with screw side into profile groove of movable construction part
- 2: Tighten the screw
- 3: Slide the completely mounted movable part into the grooves of the guiding profiles. Secure the movable part against falling out with screws at both ends

## GLIDE-ROLL ELEMENT PARALLEL

part no. 21.1714/0

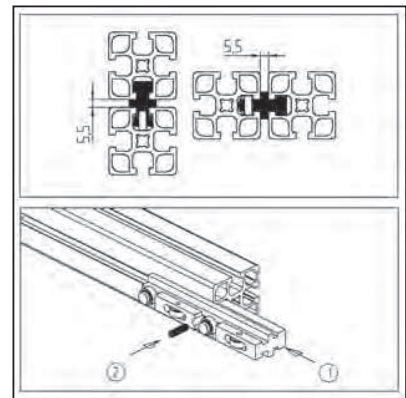
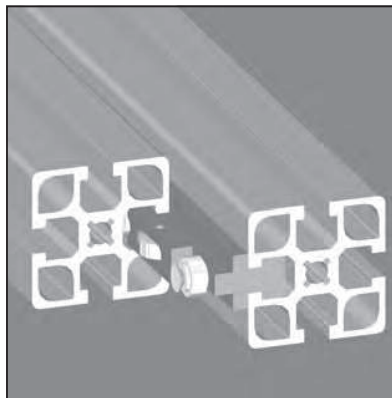
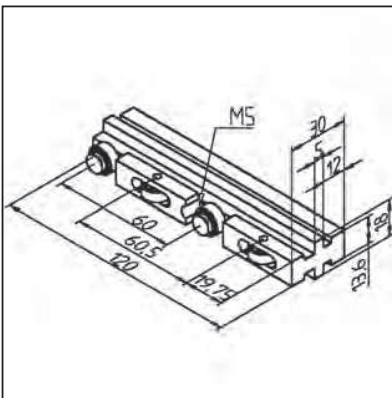

### TECHN. DATA / ITEMS SUPPLIED

- Hard plastic black, extremely wear resistant
- 1 clamping screw, steel, zinc plated
- 4 built-in ball-bearings
- Weight 0,060 kg
- F max 300 N

### APPLICATIONS

- Guide for sliding doors, lifting-doors, workpiece-slides, light linear guides
- Both slots are parallel to each other for construction of flush sliding doors

### ASSEMBLY

- 1: Insert the element with screw side into profile groove of movable construction part
- 2: Tighten the screw
- 3: Slide the completely mounted movable part into the grooves of the guiding profiles. Secure the movable part against falling out with screws at both ends

## SLIDE ELEMENT

part no. 21.1795/0

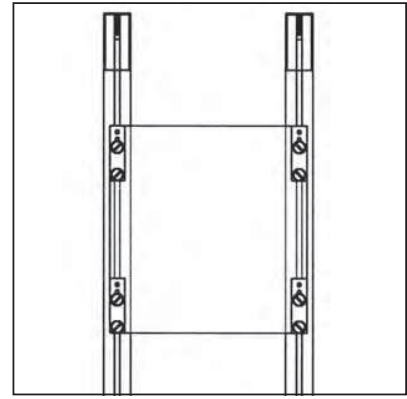
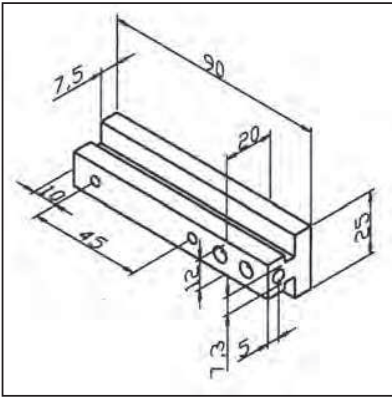

### TECHN. DATA / ITEMS SUPPLIED

- Hard plastic black, highly wear-resistant
- Ready for use with rope-bore and clamp
- Weight 0,029 kg

### APPLICATIONS

- Guide for light lifting doors and in same function connection of door element and counterweight
- Especially suitable for direct attachment on panel elements without frame

### ASSEMBLY

- Connect the cable of the counterweight with slide element
- Secure cable end with clamp
- Screw into the groove of the vertical profile
- Screw panel element

## GUIDE FOR SLIDING DOOR 30

part no. 22.1159/0

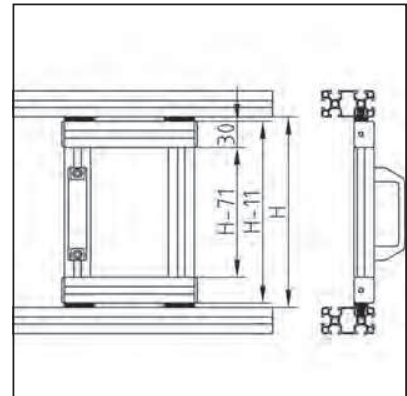
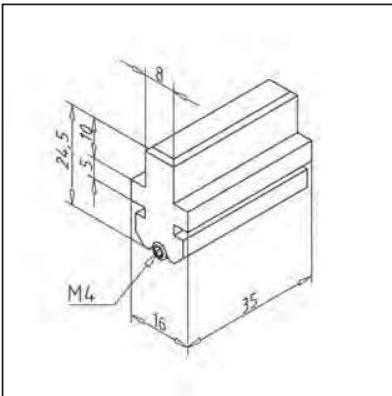

### TECHN. DATA / ITEMS SUPPLIED

- PE-UHMW, black
- 1 fixing screw
- For 1 door element 4 guides are necessary
- Weight 0,01 kg

### APPLICATIONS

- Sliding doors
- Sliding elements
- Workpiece-slides, drawers
- Subsequent mounting of sliding doors into existing constructions possible

### ASSEMBLY

- Insert guidings laterally, mount cover caps
- Insert guidings laterally, mount cover caps

## GUIDE FOR SLIDING DOOR

part no. 22.1079/0

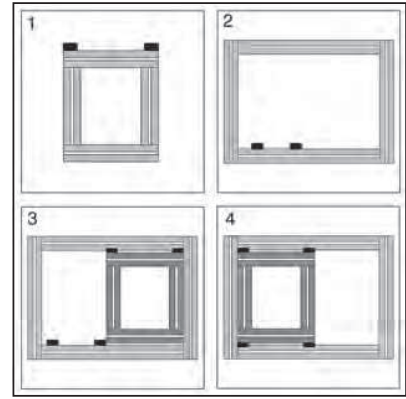
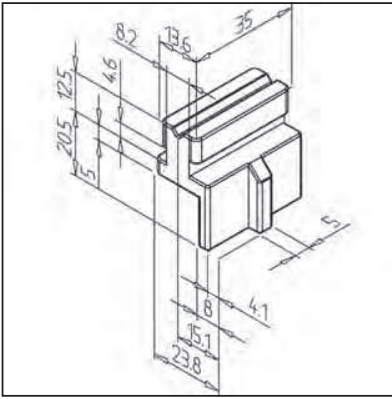

### TECHN. DATA / ITEMS SUPPLIED

- Plastic PA 6.6, black
- 1 screw
- For 1 door element 4 guides are necessary
- Weight 0,029 kg

### APPLICATIONS

- Sliding doors
- Sliding elements
- Workpiece-slides, drawers
- For a simultaneous guidance of 2 elements in 1 profile groove
- Subsequent mounting of sliding doors into existing constructions possible

### ASSEMBLY

- 1: Fasten the upper guide to the frame of the door element
  - 2: Insert the lower guide into the frame construction
  - 3: Insert the door element
  - 4: Slide it into the lower guide and secure at desired position
- Mount second door element
  - Allowance: see page

## FOLDING DOOR SUPPORT

part no. 22.1148/0

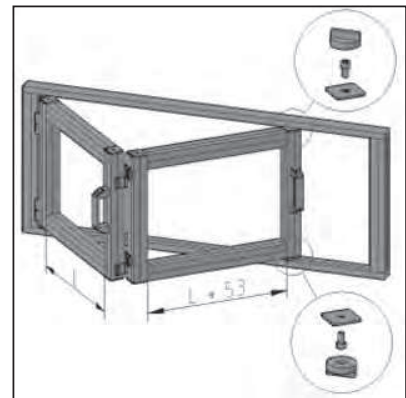
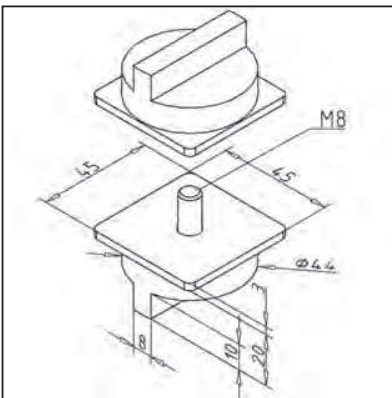

### TECHN. DATA / ITEMS SUPPLIED

- 2 slide elements; plastic, black
- Fastening kit and end caps 45 x 45 AL
- Weight 0,084 kg

### APPLICATIONS

- Slide element for guiding of folding doors
- Guiding in profile grooves

### ASSEMBLY

- Mounting of end caps with supplied fastening kit on front of door profile
- Insert slide elements into profile grooves
- Insert mounted screws into drill hole of slide element
- Use always in pairs
- Measures valid for profiles 45x45 for door mounted with hinge **part no. 21.1378/0**





## SLIDING DOOR PROFILE

part no. 20.1038/0

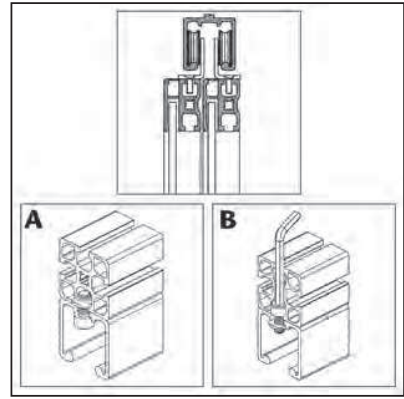
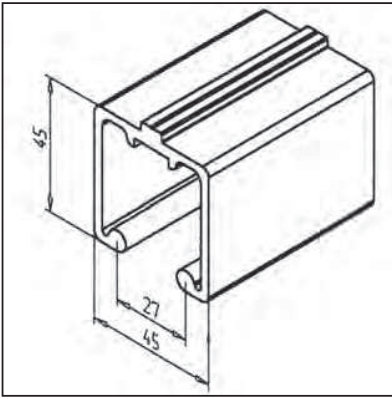

### TECHN. DATA / ITEMS SUPPLIED

- Ix =	15,347 cm <sup>4</sup>
- Iy =	15,597 cm <sup>4</sup>
- wx =	5,912 cm <sup>3</sup>
- wy =	6,932 cm <sup>3</sup>
- Weight	1,474 kg/m
- Length	6 m
- Packing unit	48 m

### APPLICATIONS

- Two wing sliding doors
- One wing sliding doors

### ASSEMBLY

- Drill Ø 8,5 mm holes in centering groove; bore pitch: 250 - 400 mm depending on the load
- A) Position M8 F square nuts in the supporting profile and fasten the sliding door profile with M8 x 25 hex socket cap screw
- B) Drill holes or step holes in the supporting profile and insert the square nuts in the sliding profile; the nuts are secured against torsion

## ROLLER ELEMENT FOR SLIDING DOOR

part no. 21.2000/0

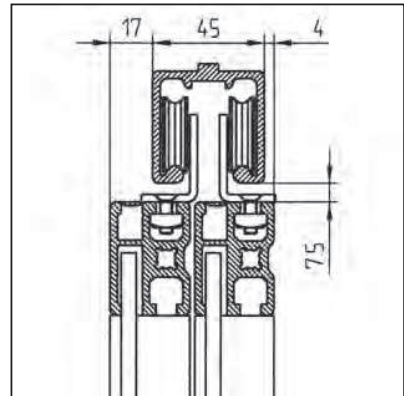
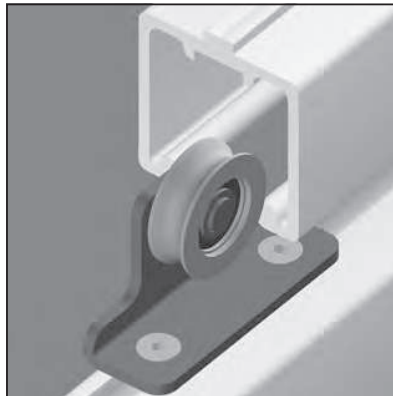
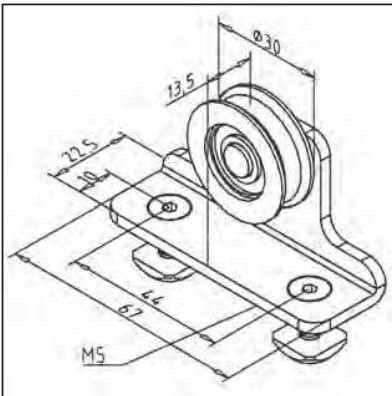

### TECHN. DATA / ITEMS SUPPLIED

- Plastic roller with ball-bearing	
- Zinc plated steel support	
- Fastening kit	
- Weight	0,080 kg
- Load max./roller	600 N

### APPLICATIONS

- Easy-running, multi-wing sliding doors in guard units, exhibition stands, testing units, etc.

### ASSEMBLY

- Fasten the roller elements on profile groove; use fastening kit
- Insert the doors in the sliding rail profile and gently swing out the doors at their bottom end
- Secure the sliding door at the bottom with locking pins, sliding rails 8N **part no. 22.1085/0** or U-Profile **part no. 21.2002/0** against swinging

## STOP FOR SLIDING DOOR K

part no. 21.2019/0

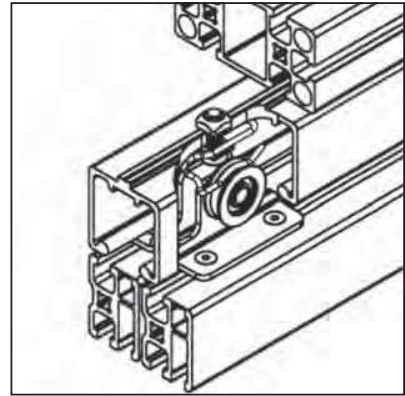
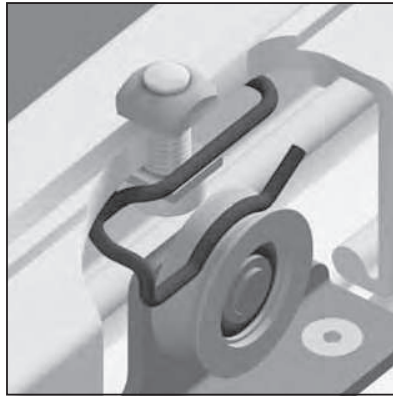
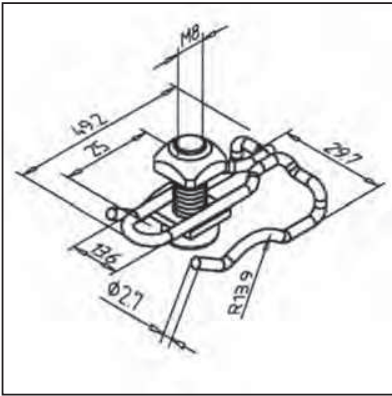

### TECHN. DATA / ITEMS SUPPLIED

- Spring steel wire

---

- Fastening kit

---

- Weight 0,010 kg

### APPLICATIONS

- Stop for sliding doors in their end positions (open / closed)

### ASSEMBLY

- Mark end position of the wheel

---

- Bore drill Ø 8,5 m in sliding door profile

---

- Use fastening kit

## ANTI LIFT FOR SLIDING DOOR

part no. 21.2003/0

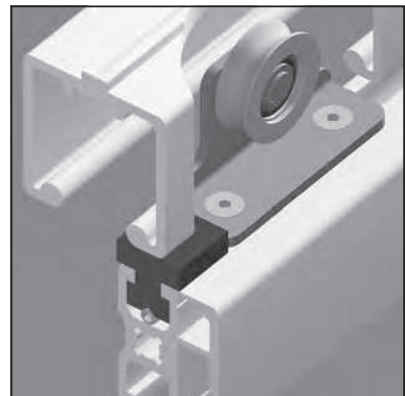
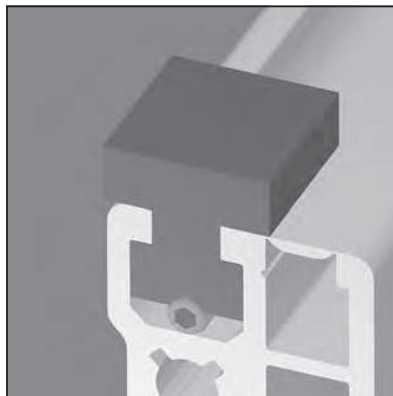
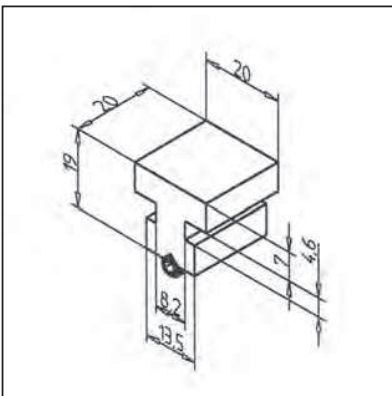

### TECHN. DATA / ITEMS SUPPLIED

- Hard plastic, black

---

- Fastening kit

---

- Weight 0,010 kg

### APPLICATIONS

- Securing of sliding doors against lift off

---

- Reduction of pendulum motion

### ASSEMBLY

- Slip lift for sliding door in upper profile groove of the door-element

---

- Secure the position by the included set screw horizontally in profile groove underneath antilift

---

- Mount end cap

## U-BAR FOR SLIDING DOOR

part no. 21.2002/0

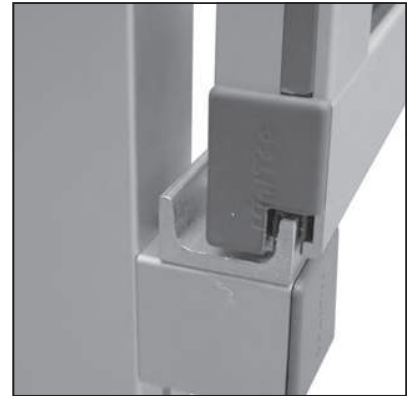
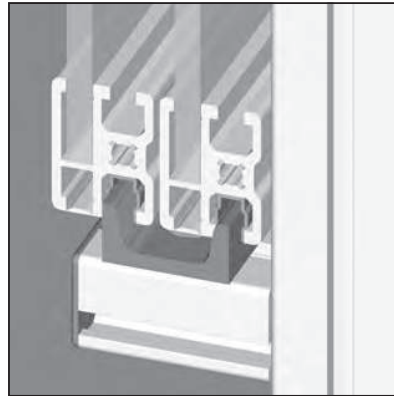
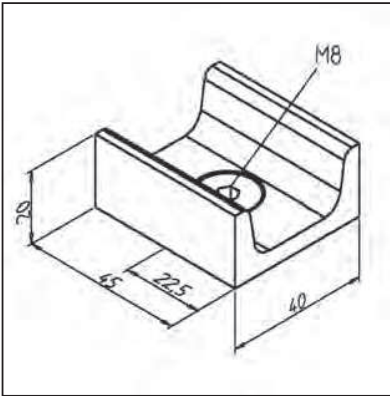

### TECHN. DATA / ITEMS SUPPLIED

- Steel, zinc plated
- Fastening kit
- Weight 0,012 kg

### APPLICATIONS

- Securing of sliding doors against lateral swinging

### ASSEMBLY

- Hang up the doors
- Mount U-Bar on profile (-60 mm), slide in position and fix
- For smooth movement provide profile grooves with cover profile

## ROLLING DOOR WITH DRIVE

part no. diverse

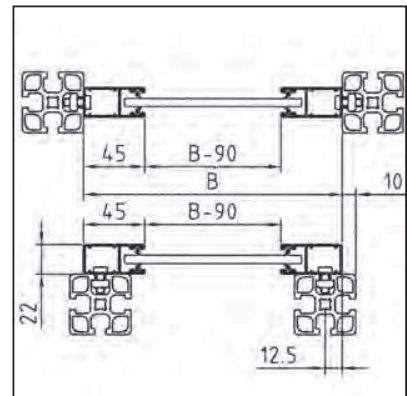
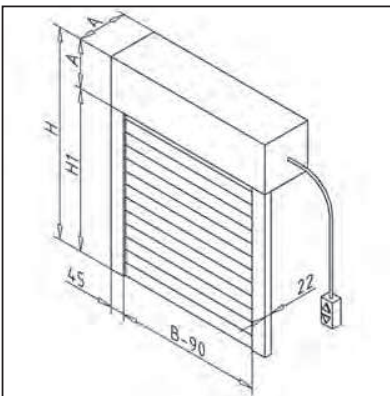

### TECHN. DATA / ITEMS SUPPLIED

- Aluminium, powder coated, silver
- 2 lateral guide rails, housing
- Electrical drive 230 V
- Without switch
- Max. width 2,70 m
- Cable length 2 m
- Please indicate width B and dimension H

### APPLICATIONS

- Cupboard for instruments
- Tools boxes
- Computer racks
- Counters
- Machine guards

### ASSEMBLY

- Assemble lateral guides with housing
- Fix guides and housing in frame
- Housing A = 152, H up to 1,70 m, part no. 29.0402/0
- Housing A = 167,5, H up to 2,20 m, part no. 29.0403/0
- Housing A = 181, H up to 2,70 m, part no. 29.0404/0
- Stroke H1: H-A

## ROLLING DOOR WITH DRIVE

part no. 29.0405/0

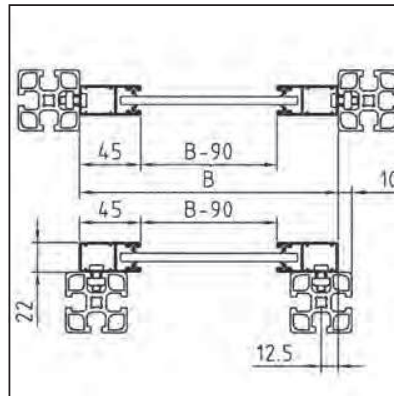
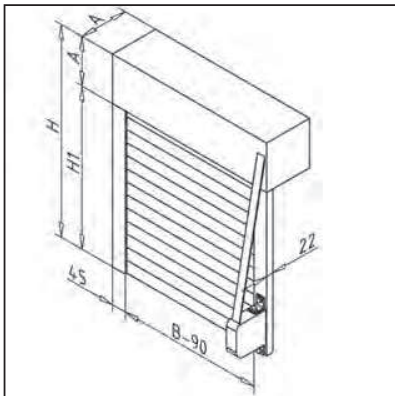

### TECHN. DATA / ITEMS SUPPLIED

- Aluminium, powder coated, silver
- 2 lateral guide rails, housing
- Max. width 2,70 m
- Please indicate width B and dimension H

### APPLICATIONS

- Cupboard for instruments
- Tools boxes
- Computer racks
- Counters
- Machine guards

### ASSEMBLY

- Assemble lateral guides with housing
- Fix guides and housing in frame
- Stroke H1: H-A

## ROLLING DOOR WITH DRIVE

part no. 29.0406/0

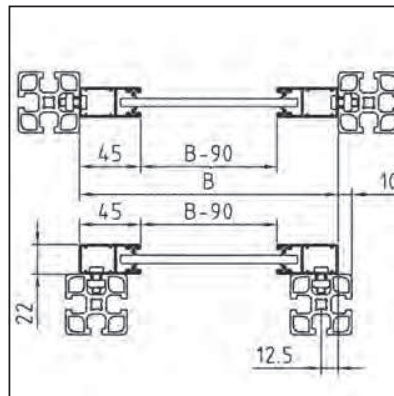
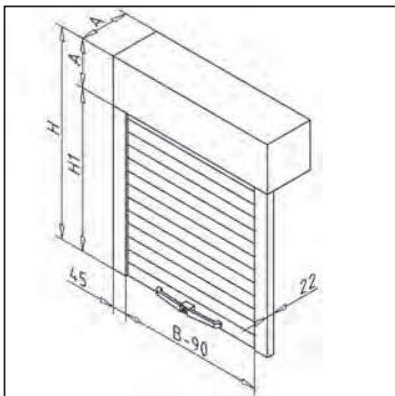

### TECHN. DATA / ITEMS SUPPLIED

- Aluminium, powder coated, silver
- 2 lateral guide rails, housing
- Max. width 2,70 m
- Please indicate width B and dimension H

### APPLICATIONS

- Cupboard for instruments
- Tools boxes
- Computer racks
- Counters
- Machine guards

### ASSEMBLY

- Assemble lateral guides with housing
- Fix guides and housing in frame
- Stroke H1: H-A