

PNEUMATIC SYSTEM



Profilex s.a.
 6b, Z.I. In den Allern
 L-9911 Troisvierges
 Phone LU : +352 99 89 06
 Phone BE : +32 28 88 16 29
 Fax : +352 26 95 73 73
info@profilex-systems.com
www.profilex-systems.com

The profiles can be used as an air guide and are also visually appealing and economical. The MiniTec standard profiles are particularly well suited for compressed air supply.

Commercially available connectors can be used without special connection components.

All standard pneumatic elements with thread G 1/8" und G 1/4" can be used with all standard MiniTec profiles. Fixing is possible at any desired point.

The standard profile 45 x 45 provides 4 pipes; in the larger profiles 4 pipes and 1 air chamber are included. Parts are required for faceconnection.

The Ø 11.7 mm bore in the standard profiles can be re-bored to G 1/4" for fastening standard screw connectitons. Max. pressure: for round chambers 20 bar; for others: 8 bar.

Usable air pipings

All dimensions in mm²

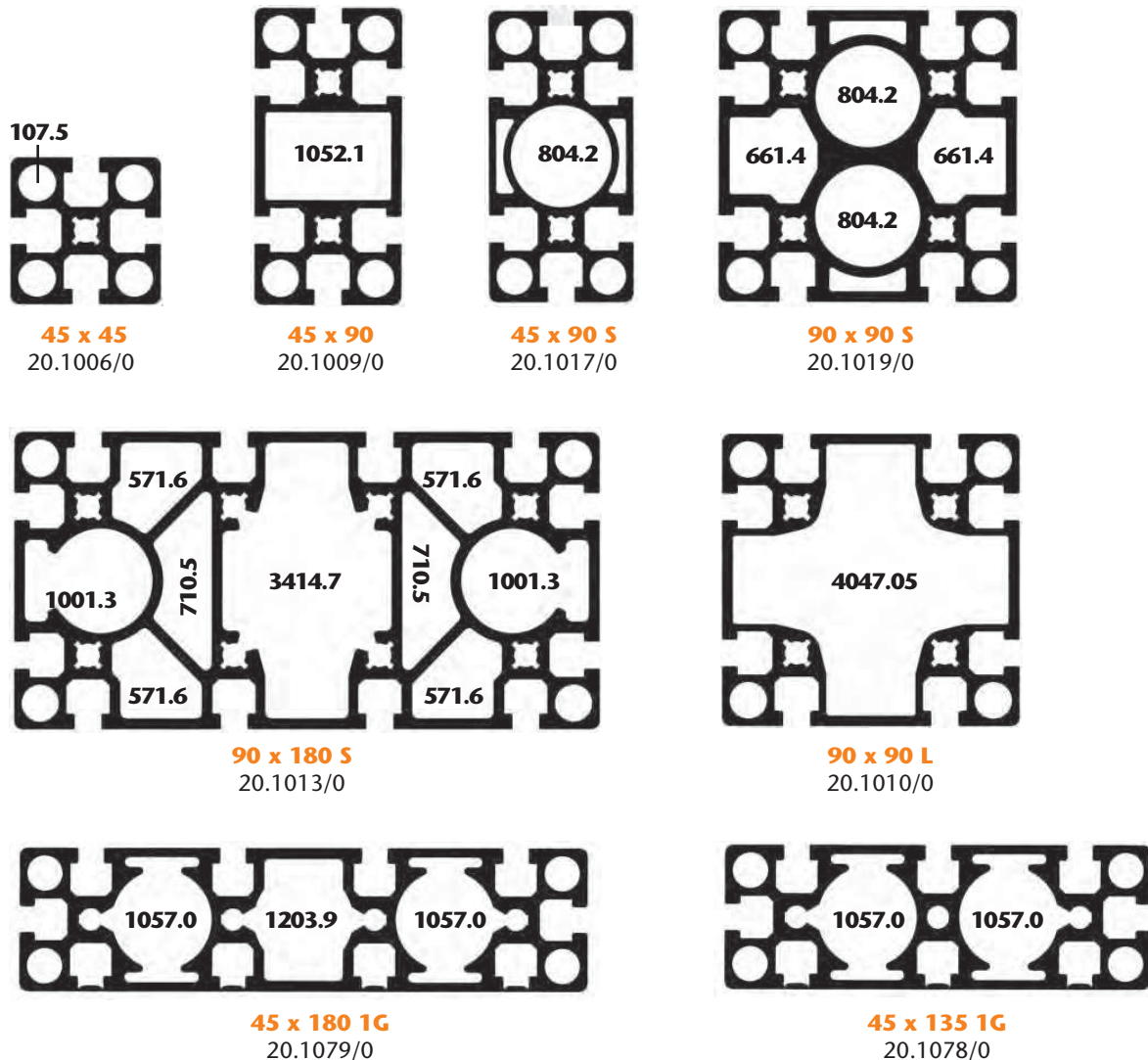

PNEUMATIC SYSTEM

PNEUMATIC CONNECTION PLATE 45
 PNEUMATIC CONNECTION PLATE 45 X 90
 PNEUMATIC CONNECTION PLATE 90

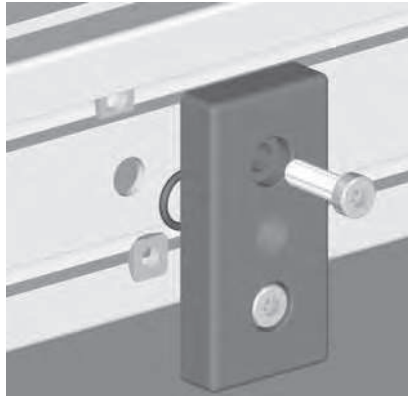

THREAD	WEIGHT	PART NO.
G 1/8"	0.170 kg	24.1107/0
G 1/4"	0.168 kg	24.1107/2
G 3/8"	0.165 kg	24.1107/3

PNEUMATIC CONNECTION PLATE 45

Technical Data/Items supplied

- Aluminium pressure die casting, powder-coated, grey
- One O-ring
- Fastening kit

Applications

- Lateral connection of pneumatic connections at profiles 45 x 90 and 90 x 90

Assembly

- Fasten on to profile grooves with fastening kit
- Drill \varnothing 12 mm hole in the profile center.

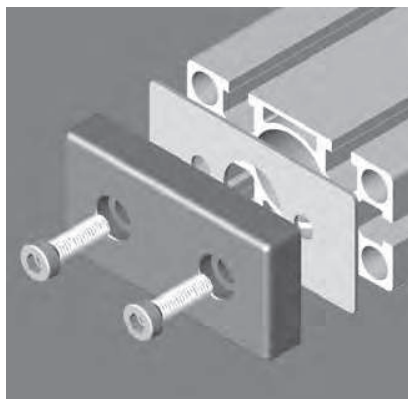

THREAD	WEIGHT	PART NO.
G 1/8"	0.181 kg	24.1105/0
G 1/4"	0.178 kg	24.1105/2
G 3/8"	0.174 kg	24.1105/3

PNEUMATIC CONNECTION PLATE 45 X 90

Technical Data/Items supplied

- Aluminium pressure die casting, powder-coated, grey
- Sealing plate
- Fastening kit

Applications

- Closing of chambers of profiles 45 x 90 for connection of pneumatic couplings

Assembly

- Insert sealing plate
- Fasten on to 2 central bores \varnothing 7.5 mm with fastening kit

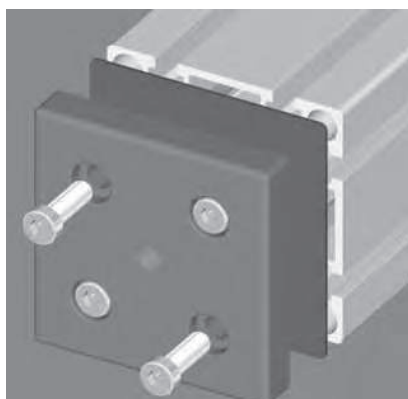

THREAD	WEIGHT	PART NO.
G 1/8"	0.434 kg	24.1106/0
G 1/4"	0.429 kg	24.1106/2
G 3/8"	0.421 kg	24.1106/3

PNEUMATIC CONNECTION PLATE 90

Technical Data/Items supplied

- Aluminium pressure die casting, powder-coated, grey
- Sealing plate
- Fastening kit

Applications

- Closing of chambers of profiles 90 x 90 for connection of pneumatic couplings

Assembly

- Insert sealing plate
- Fasten on to 4 central bores \varnothing 7.5 mm with fastening kit

PLUG

part no. 24.1104/0

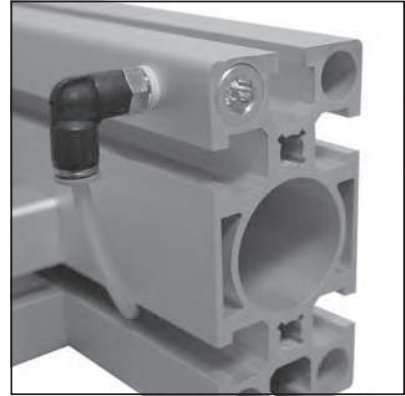
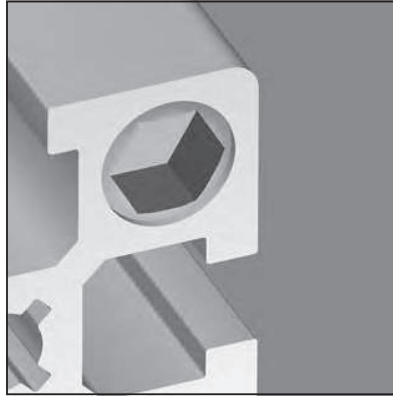
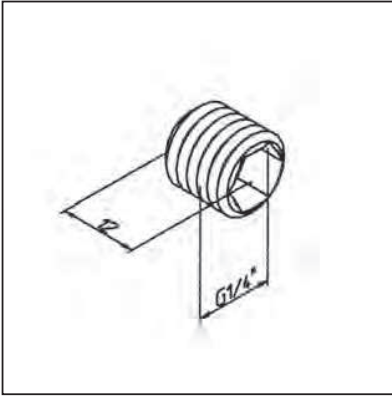

TECHN. DATA / ITEMS SUPPLIED

- Brass	
- Weight	0,006 kg

APPLICATIONS

- Closure for profile chambers Ø 11,7 mm

ASSEMBLY

- Thread the round profile chambers Ø 11,7 mm to G 1/4 "
- Screw in the plug by using sealing tape

QUICK COUPLING 1/8

part no. 24.1109/0

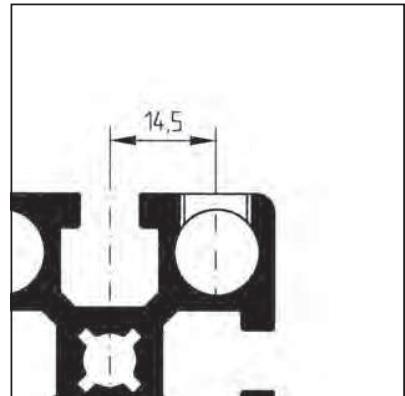
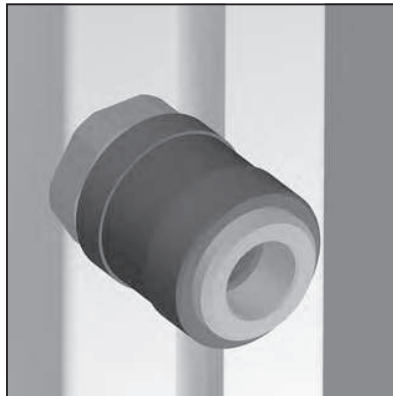
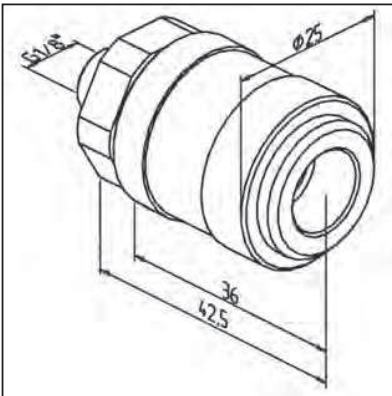

TECHN. DATA / ITEMS SUPPLIED

- Brass, nickel plated, NW 7	
- Connection G 1/8", A/F 22	
- Weight	0,064 kg

APPLICATIONS

- Pressed air connection at any desired point on profile surface or faces, Ø 11,7 mm

ASSEMBLY

- Bore thread G 1/8" in profile surface; distance from center of profile groove: 14,5 mm

QUICK COUPLING 1/4

part no. 24.1110/0

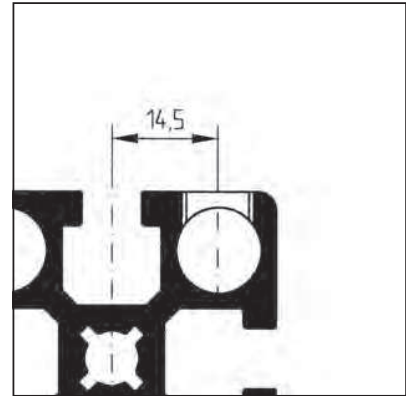
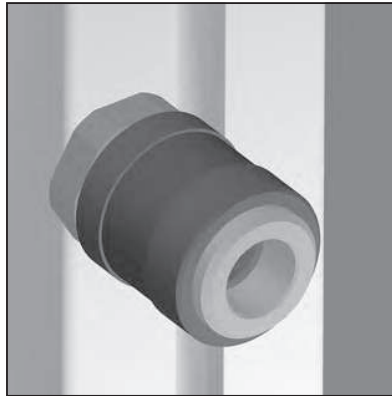
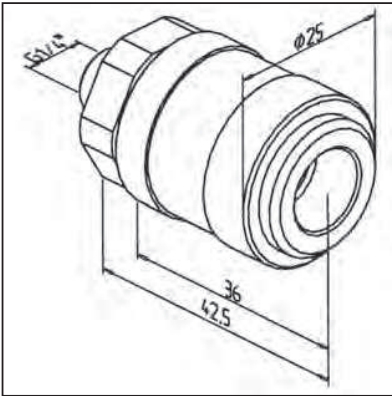
**TECHN. DATA / ITEMS SUPPLIED**

- Brass, nickel plated, NW 7
- Connection G 1/4", A/F 22
- Weight 0,065 kg

APPLICATIONS

- Pressed air connection at any desired point on profile surface or faces, \varnothing 11,7 mm

ASSEMBLY

- Bore thread G 1/4" in profile surface; distance from center of profile groove: 14,5 mm

PNEUMATIC END PLATE 45 X 90

part no. 24.1105/7

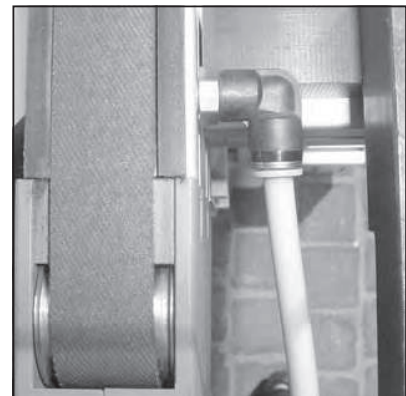
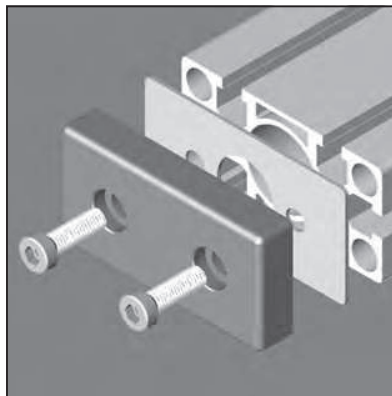
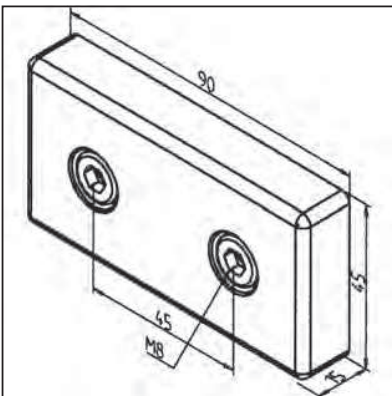
**TECHN. DATA / ITEMS SUPPLIED**

- Aluminium GD, powder coated, grey
- Sealing plate
- Fastening kit
- Weight 0,181 kg

APPLICATIONS

- Closing of chamber ends of profiles 45 x 90

ASSEMBLY

- Insert sealing plate
- Attachment on 2 central bores \varnothing 7,5 with fastening kit

PNEUMATIC END PLATE 90 X 90

part no. 24.1106/7

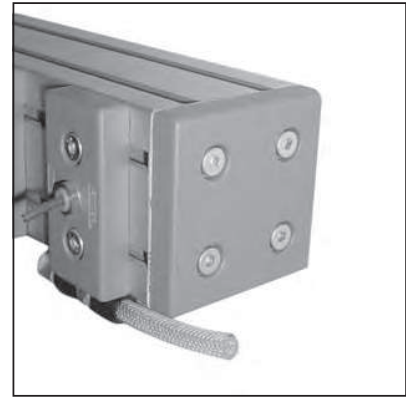
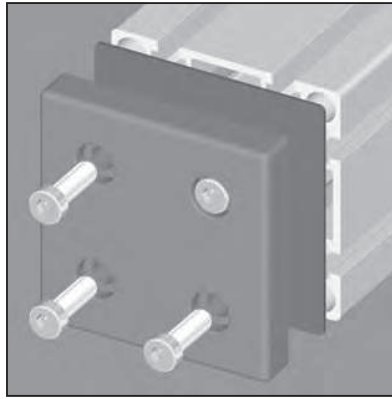
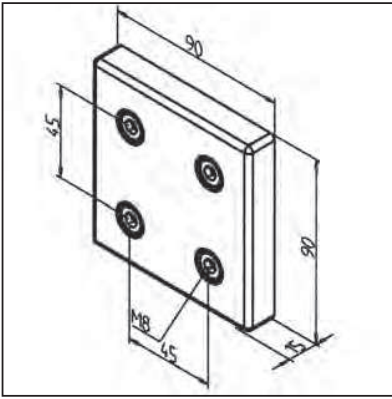

TECHN. DATA / ITEMS SUPPLIED

- Aluminium GD, powder coated, grey
- Sealing plate
- Fastening kit
- Weight 0,434 kg

APPLICATIONS

- Closing of chambers of profiles 90 x 90 for connection of pneumatic couplings

ASSEMBLY

- Insert sealing plate
- Attachment on 4 central bores $\varnothing 7,5$ with fastening kit from supply schedule

PNEUMATIC LIFTING UNIT 15

part no. 24.1201/0

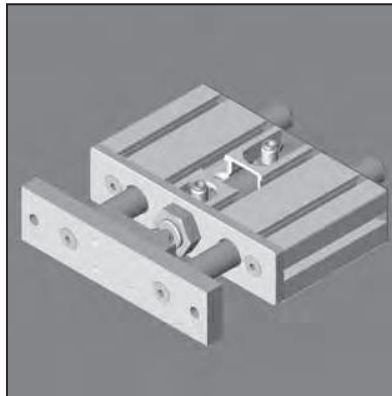
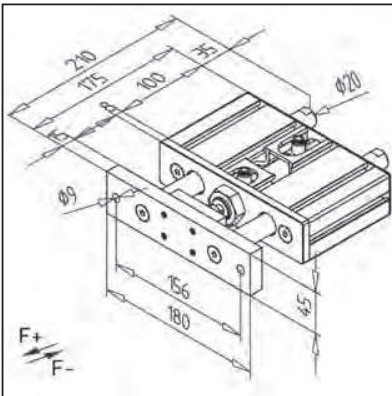

TECHN. DATA / ITEMS SUPPLIED

- Incorporated into profile 45 x 180
- Overall cylinder size $\varnothing 25$ mm
- Guide shafts $\varnothing 20$ mm
- F+ with 6 bar = 256 N
- F- with 6 bar = 220 N
- Stroke = 15 mm
- Completely assembled with dual acting cylinder
- Weight 3,405 kg

APPLICATIONS

- Lifting and lowering of loads
- Attachment for gripper loc. Cit.
- Positioning of parts

ASSEMBLY

- With mounting angle on profile construction
- Other stroke lengths on request

PNEUMATIC LIFTING UNIT 50

part no. 24.1205/0

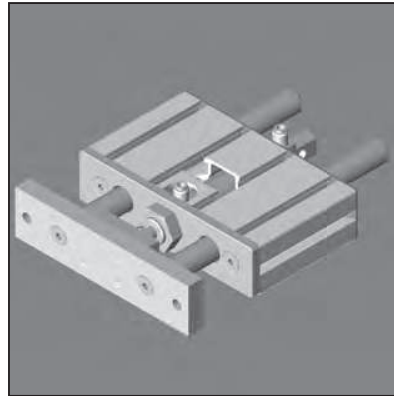
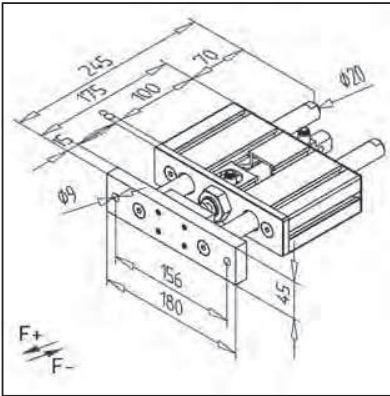

TECHN. DATA / ITEMS SUPPLIED

- Incorporated into profile 45 x 180
- Cylinder Ø 25 mm
- Guide shafts Ø 20 mm
- F+ with 6 bar = 265 N
- F- with 6 bar = 220 N
- Stroke = 50 mm
- Completely assembled with dual acting cylinder
- Weight 3,45 kg

APPLICATIONS

- Lifting and lowering of loads
- Attachment for gripper loc. Cit.
- Positioning of parts

ASSEMBLY

- With mounting angle on profile construction
- Other stroke lengths on request

PNEUMATIC LIFTING UNIT 100

part no. 24.1210/0

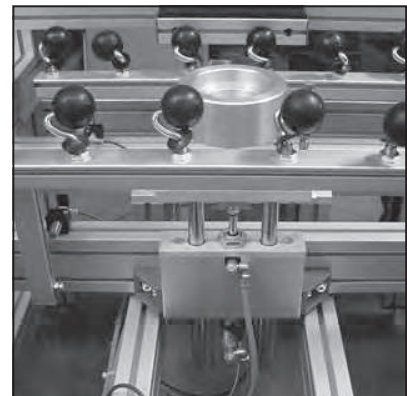
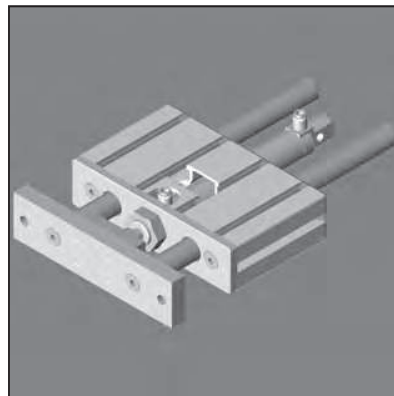
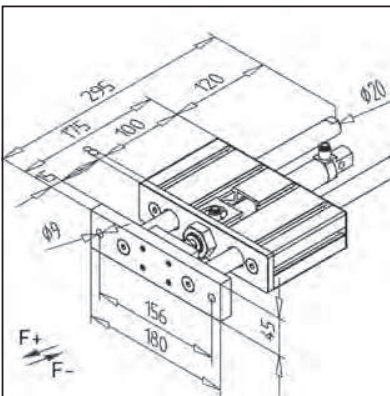

TECHN. DATA / ITEMS SUPPLIED

- Incorporated into profile 45 x 180
- Cylinder Ø 25 mm
- Guide shafts Ø 20 mm
- F+ with 6 bar = 265 N
- F- with 6 bar = 220 N
- Stroke = 100 mm
- Completely assembled with dual acting cylinder
- Weight 3,52 kg

APPLICATIONS

- Lifting and lowering of loads
- Attachment for gripper loc. Cit.
- Positioning of parts

ASSEMBLY

- With mounting angle on profile construction
- Other stroke lengths on request



Profilex s.a.

6b, Z.I. In den Allern
L-9911 Troisvierges
Phone LU : +352 99 89 06
Phone BE : +32 28 88 16 29
Fax : +352 26 95 73 73

info@profilex-systems.com
www.profilex-systems.com